



www.sihga.com

Monitorix® WET

INNOVATIVE CONSTRUCTION TECHNOLOGY
AND SUPPORT FOR THE FUTURE

MA Nr. 60301/24/10/EN

TAKE THE BEST



Assembly video



SIHGA® GmbH | Gewerbepark Kleinreith 4 | 4694 Ohlsdorf bei Gmunden | AUSTRIA
Tel.: +43 7612 / 74 370 - 0 | E-Mail: info@sihga.com | www.sihga.com

1

Packaging unit: 25 m / 100 m
Maximum length of a WET sensor strip: 20 m
Sensor width: 22 mm

Do not open the packaging



Cut off the required length



One WET sensor strip -> one slot on the electronics.
WET sensor strips can be split.

2

Define installation

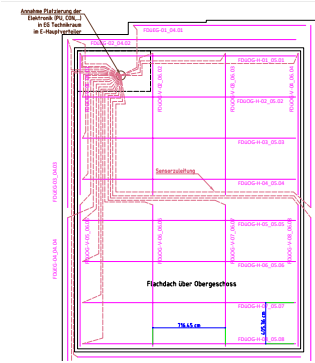

Transfer the installation plan to the area where the sensors are to be installed.

3

Laying the WET sensor strip



At start and end points as well as corner and crossing points, create a separating layer to the substrate!

Fastening approx. every 2 m
(no separating layer necessary)



4

Corner formation

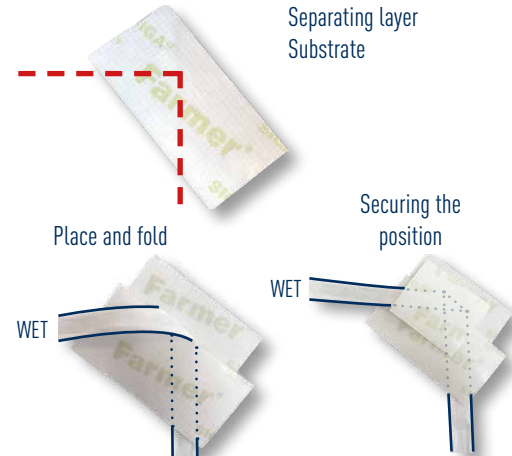

5

Crossing point

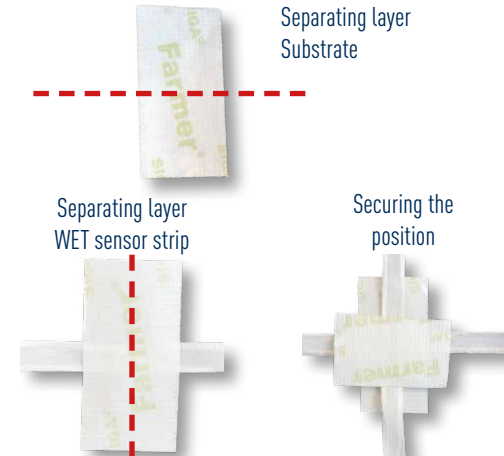

6

Accessories



7

WET sensor strip -> sensor cable connection WET/-GUARD

Expose the sensor wire (approx. 11 mm)

Open sensor clamp

Strip 2-pole insulation from sensor cable (approx. 11 mm)

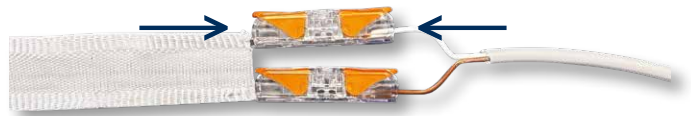

NOTE: The WET sensor strip can also be cut into pieces.

Example: 5 linear metres of WET sensor strip - sensor terminals - sensor cable WET/-GUARD - sensor terminals - 5 linear metres of WET sensor strip

8

Terminal points / connection

- make connections on the sensor side
- open gelbox
- place sensor terminals in gelbox

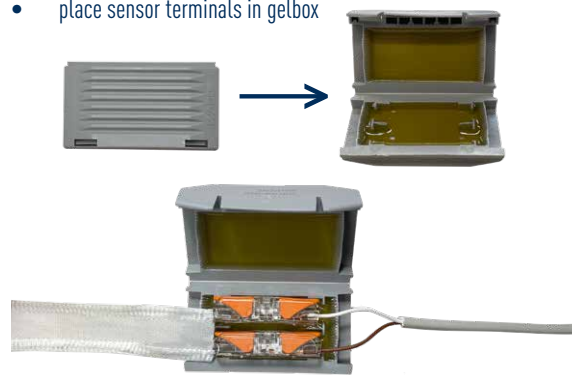

9

Terminal points / connection

- close the gelbox and form a relief loop
- secure position (e.g. adhesive tape)

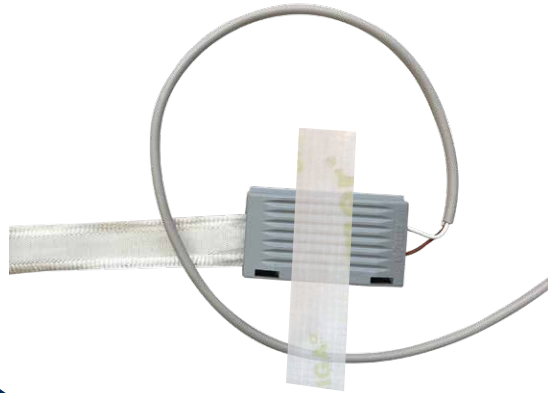

10

Laying the sensor cable WET/-GUARD

Sensor cables WET/-GUARD are routed from the WET sensor strip to the electronics (processor unit or connector). Ensure that the cables are laid neatly and tidily.

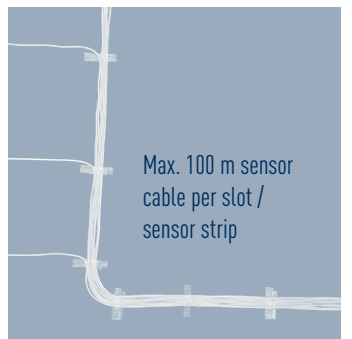

Max. 100 m sensor cable per slot / sensor strip

11

Labelling sensor cable WET/-GUARD

Use the Monitorix stickers supplied with the cables (VP 2) for easier cable labelling.

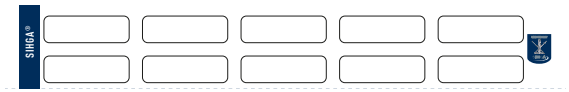

12

Connecting the electronics to processor unit

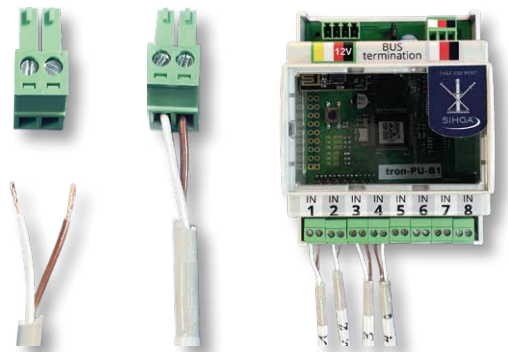

13

Documentation

Complete the attached form (item list)!

Send the completed form including image documentation to monitoring@sihga.com or upload it to the SIHGA® Cockpit!

Download: <https://www.sihga.com/service/download/monitorix/>

